

SEWER MASTER PLAN SUNSET BEACH SANITARY DISTRICT

ORANGE COUNTY, CALIFORNIA
NOVEMBER, 2020

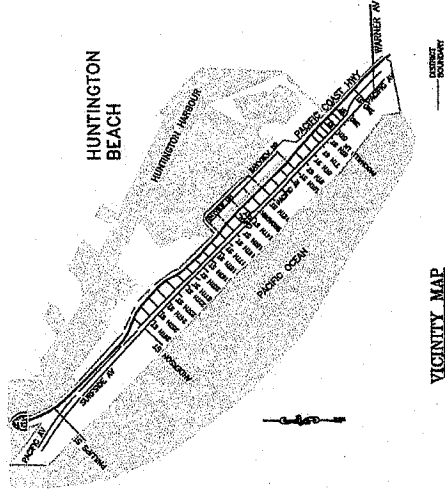
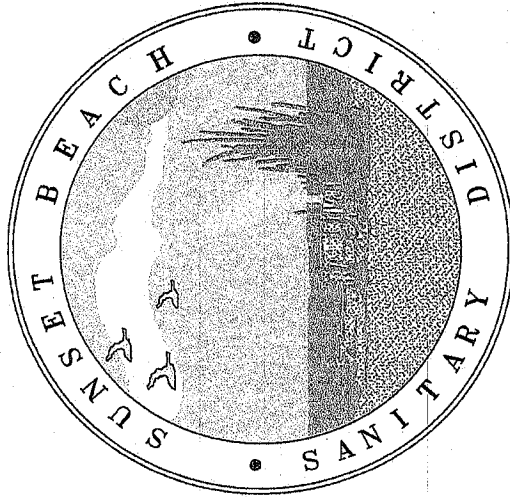

BOARD OF DIRECTORS

- GRAHAM K. HOAD, DIRECTOR/PRESIDENT
- JOHN H. WOODS, DIRECTOR/SECRETARY
- BERNARD H. HARTMANN, DIRECTOR/TREASURER
- K.C. COULTRUP, DIRECTOR
- DAVID E. EVANS, DIRECTOR

DISTRICT ENGINEER: TOMAS M. DAVES, P.E.



JONES, CAHIL & ASSOCIATES
CONSULTING ENGINEERS
18090 Beach Boulevard - Huntington Beach
California 92648 - (714) 948-0566
e-mail: jca@jonescahill.com

REVISIONS	APPROVALS														
<table border="1"> <thead> <tr> <th>REV</th> <th>DATE</th> <th>DESCRIPTION</th> <th>APP</th> </tr> </thead> <tbody> <tr> <td>Δ</td> <td>4/13/20</td> <td>ADDED LATERALS AT A1-A118; B5-B118; C17-C44, PER VIDEO</td> <td></td> </tr> </tbody> </table>	REV	DATE	DESCRIPTION	APP	Δ	4/13/20	ADDED LATERALS AT A1-A118; B5-B118; C17-C44, PER VIDEO		<table border="1"> <thead> <tr> <th>NAME</th> <th>DATE</th> </tr> </thead> <tbody> <tr> <td><i>[Signature]</i></td> <td>4/13/2020</td> </tr> <tr> <td>RICHARD H. CAHL</td> <td>RCE 21005</td> </tr> </tbody> </table>	NAME	DATE	<i>[Signature]</i>	4/13/2020	RICHARD H. CAHL	RCE 21005
REV	DATE	DESCRIPTION	APP												
Δ	4/13/20	ADDED LATERALS AT A1-A118; B5-B118; C17-C44, PER VIDEO													
NAME	DATE														
<i>[Signature]</i>	4/13/2020														
RICHARD H. CAHL	RCE 21005														

PREPARED UNDER THE SUPERVISION OF:
JONES, CAHIL AND ASSOCIATES

APPROVED:
SUNSET BEACH SANITARY DISTRICT

[Signature]
THOMAS M. DAVES, RCE 18424

SEWER MASTER PLAN
FACILITIES MAP
SUNSET BEACH SANITARY DISTRICT
OF ORANGE COUNTY, CALIFORNIA

SHEET: 1/9

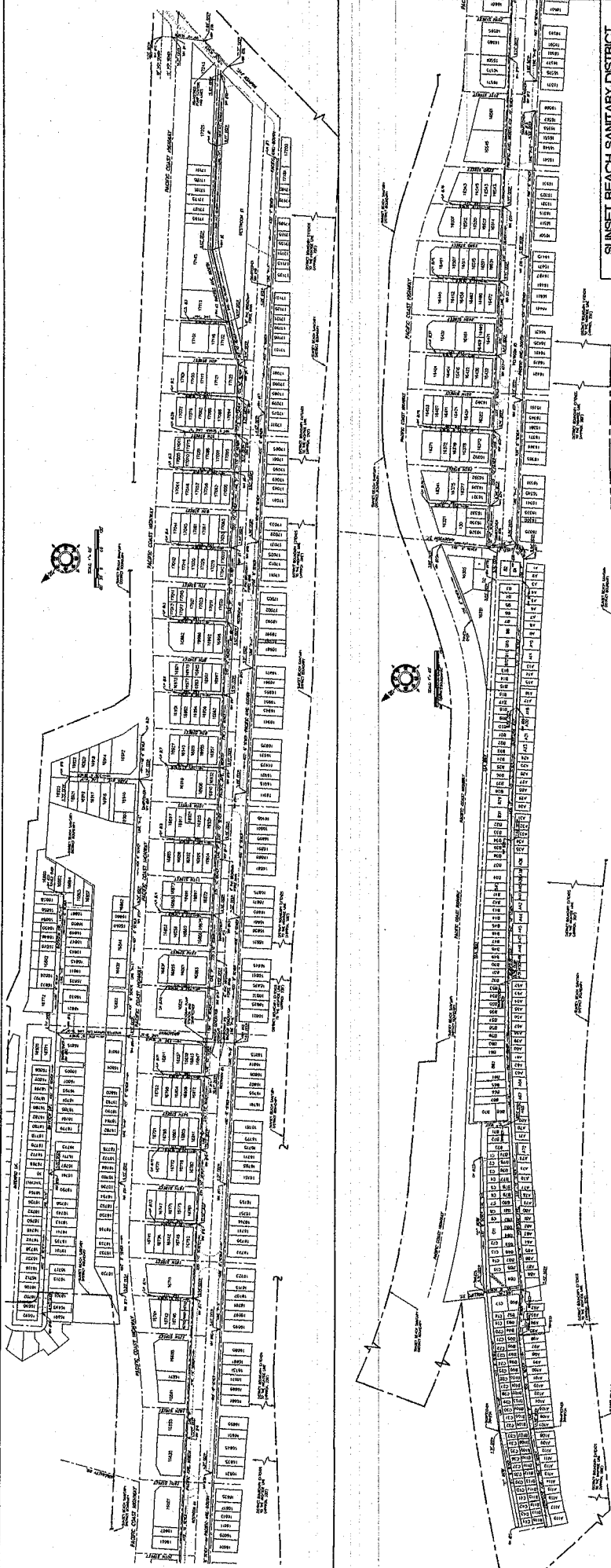

SUNSET BEACH SANITARY DISTRICT

SEWER MASTER PLAN
FACILITIES MAP

SHEET 2 OF 9

JONES, CARL & ASSOCIATES
1800 S. BAYVIEW BLVD., SUITE 200
CORONA, CA 92626
TEL: (714) 441-1111
WWW.JONESCARL.COM



JONES, CAHL & ASSOCIATES
 CONSULTING ENGINEERS
 18090 Redwood Avenue, Suite 200
 San Juan Capistrano, California 92675
 California 92675 - (714) 848-0566
 e-mail: jca@jonescahl.com



**SUNSET BEACH SANITARY DISTRICT
 SEWER MASTER PLAN
 FACILITIES MAP**

SHEET: **3/9**

SCALE: 1" = 100'

LEGEND

- SLIP LINED SEWER LINE
- SEWER LATERAL
- PROPERTY LINE
- BY-PASS PRESSURE LINE
- STREET CENTERLINE
- FLOW DIRECTION
- MANHOLE
- LAMP HOLE
- ID NUMBER

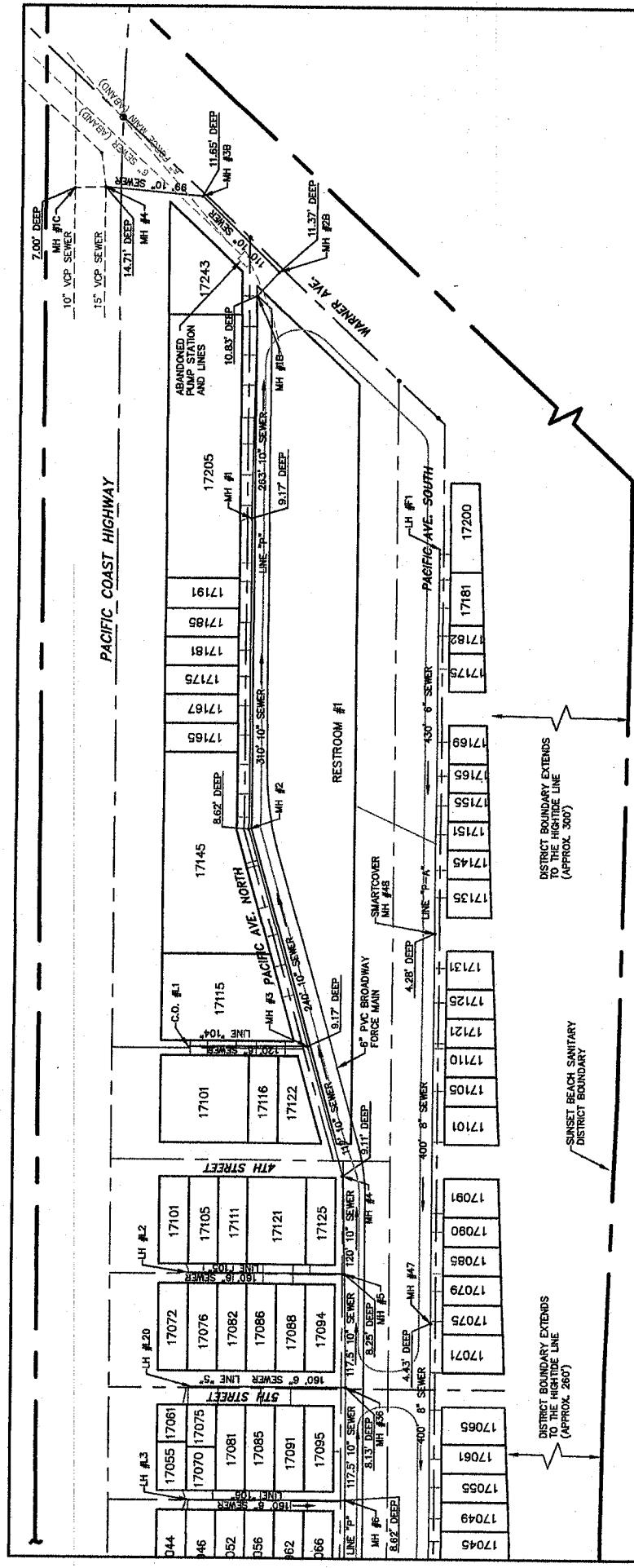

LEGEND

- SLIP LINED SEWER LINE
- SEWER LATERAL
- PROPERTY LINE
- BY-PASS PRESSURE LINE
- STREET CENTERLINE
- FLOW DIRECTION
- MANHOLE
- LAMP HOLE
- ID NUMBER

SCALE: 1" = 100'

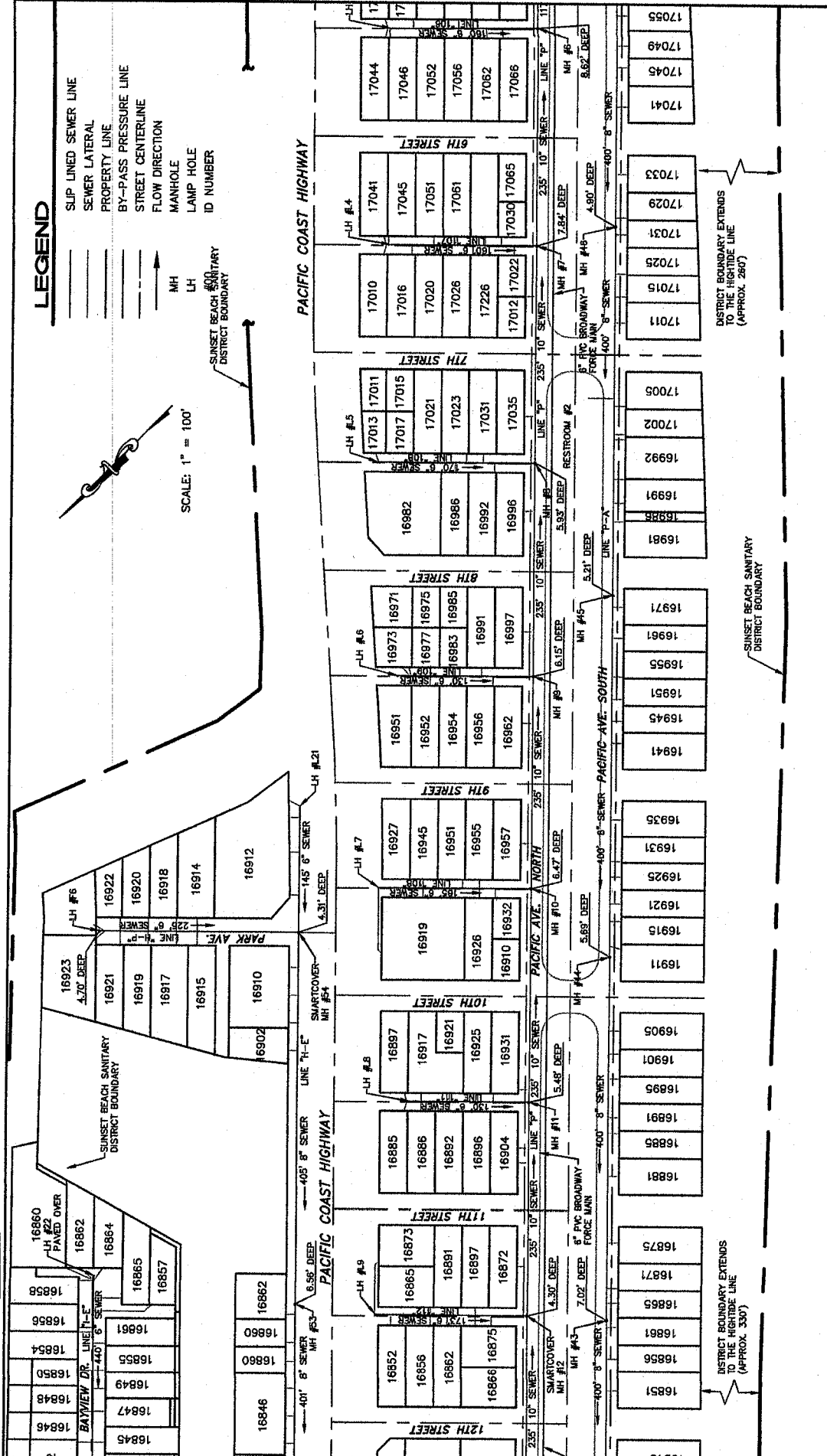

SHEET: **4/9**

SUNSET BEACH SANITARY DISTRICT
SEWER MASTER PLAN
FACILITIES MAP

JCA

JONES, CAHL & ASSOCIATES
CONSULTING ENGINEERS
18000 Pacific Coast Highway, Suite 200, Sunset Beach
California 92688 • (714) 846-7266
e-mail: jca@sunsetbeach.com

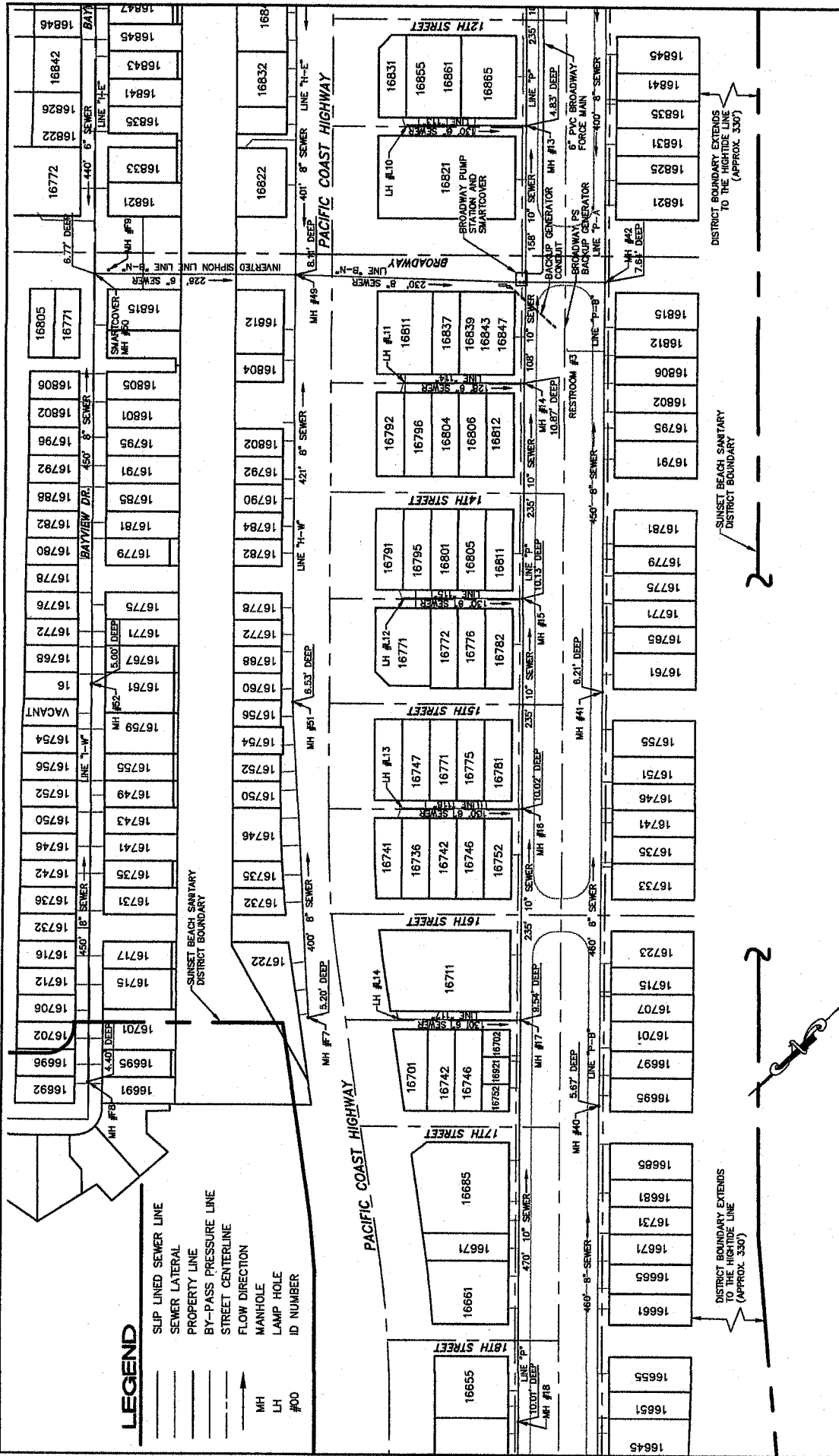

LEGEND

- SUP LINED SEWER LINE
- SEWER LATERAL
- PROPERTY LINE
- BY-PASS PRESSURE LINE
- STREET CENTERLINE
- FLOW DIRECTION
- MANHOLE
- LAMP HOLE
- ID NUMBER
- MH
- LH
- #00

SUNSET BEACH SANITARY DISTRICT
SEWER MASTER PLAN
FACILITIES MAP

SHEET: 5/9

JONES, CAHL & ASSOCIATES
CONSULTING ENGINEERS
18099 Beach Boulevard - Huntington Beach
California 92648 - (714) 848-0566
e-mail: jca@jonescahl.com



SCALE: 1" = 100'



LEGEND

- SLIP LINED SEWER LINE
- SEWER LATERAL
- PROPERTY LINE
- BY-PASS PRESSURE LINE
- STREET CENTERLINE
- FLOW DIRECTION
- MANHOLE
- LAMP HOLE
- ID NUMBER

SCALE: 1" = 100'

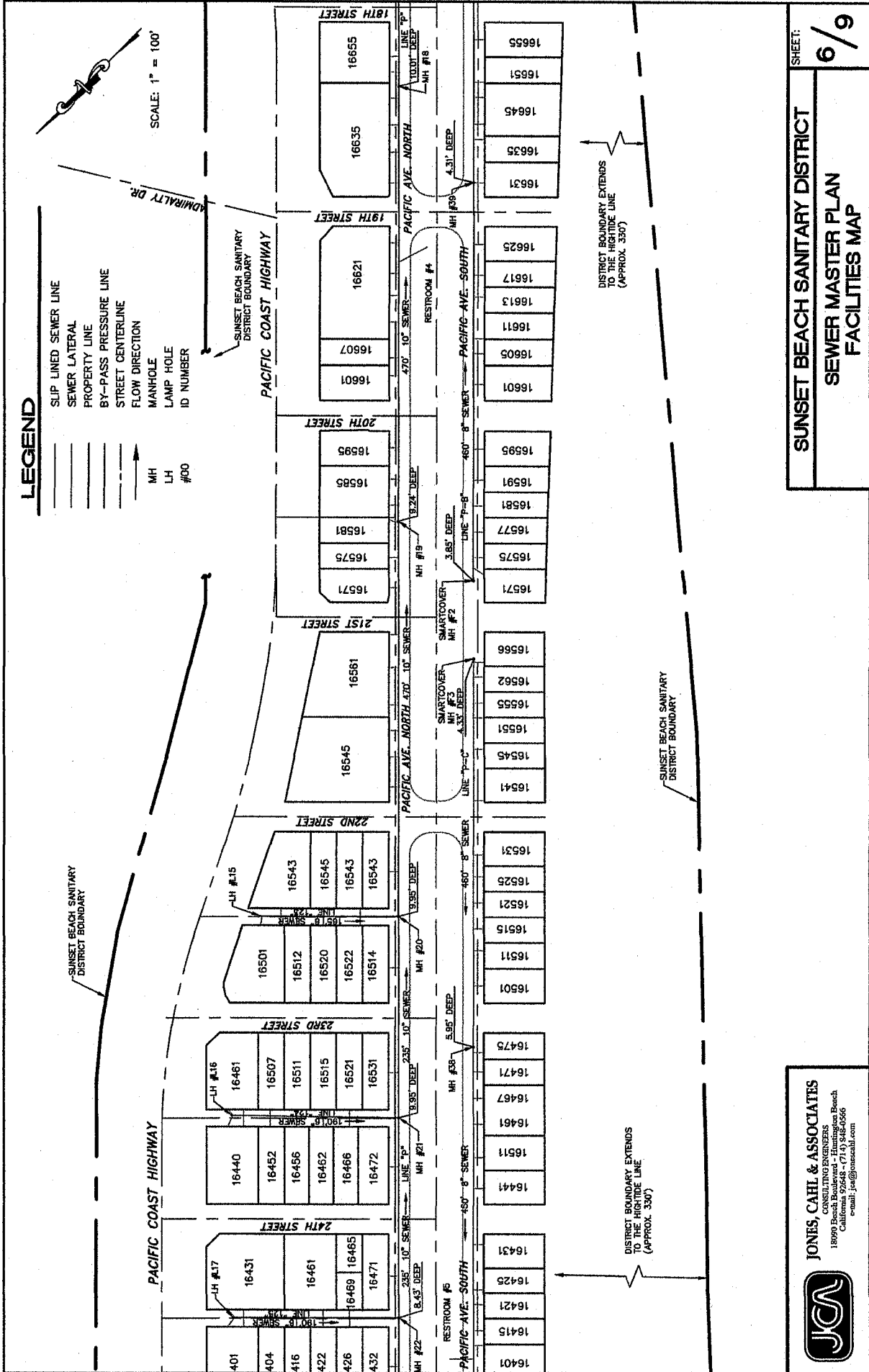

DISTRICT BOUNDARY EXTENDS TO THE HIGH TIDE LINE (APPROX. 330')

DISTRICT BOUNDARY EXTENDS TO THE HIGH TIDE LINE (APPROX. 330')

SUNSET BEACH SANITARY DISTRICT BOUNDARY

SHEET: 6/9

SUNSET BEACH SANITARY DISTRICT

SEWER MASTER PLAN

FACILITIES MAP



JONES, CAHILL & ASSOCIATES
 CONSULTING ENGINEERS
 18090 Beach Boulevard - Huntington Beach
 California 92648 - (714) 848-0566
 e-mail: jca@jonescahill.com

LEGEND

- SLIP LINED SEWER LINE
- SEWER LATERAL
- PROPERTY LINE
- BY-PASS PRESSURE LINE
- STREET CENTERLINE
- FLOW DIRECTION
- MANHOLE
- LAMP HOLE
- ID NUMBER

SCALE: 1" = 100'

SUNSET BEACH SANITARY DISTRICT BOUNDARY

PACIFIC COAST HIGHWAY

SEA WAY

SEA WAY

SEA WAY

SEA WAY

SEA WAY

SEA WAY

SEA WAY

SEA WAY

SEA WAY

SEA WAY

PACIFIC COAST HIGHWAY

ANDERSON ST.

26TH STREET

25TH STREET

DISTRICT BOUNDARY EXTENDS TO THE HIGH TIDE LINE (APPROX. 350')

SUNSET BEACH SANITARY DISTRICT BOUNDARY

JONES, CAHL & ASSOCIATES
 CONSULTING ENGINEERS
 18000 Pacific Coast Highway, Suite 200
 Redondo Beach, California 92648 • (714) 848-0556
 e-mail: jca@jonescahl.com



SUNSET BEACH SANITARY DISTRICT
SEWER MASTER PLAN
FACILITIES MAP





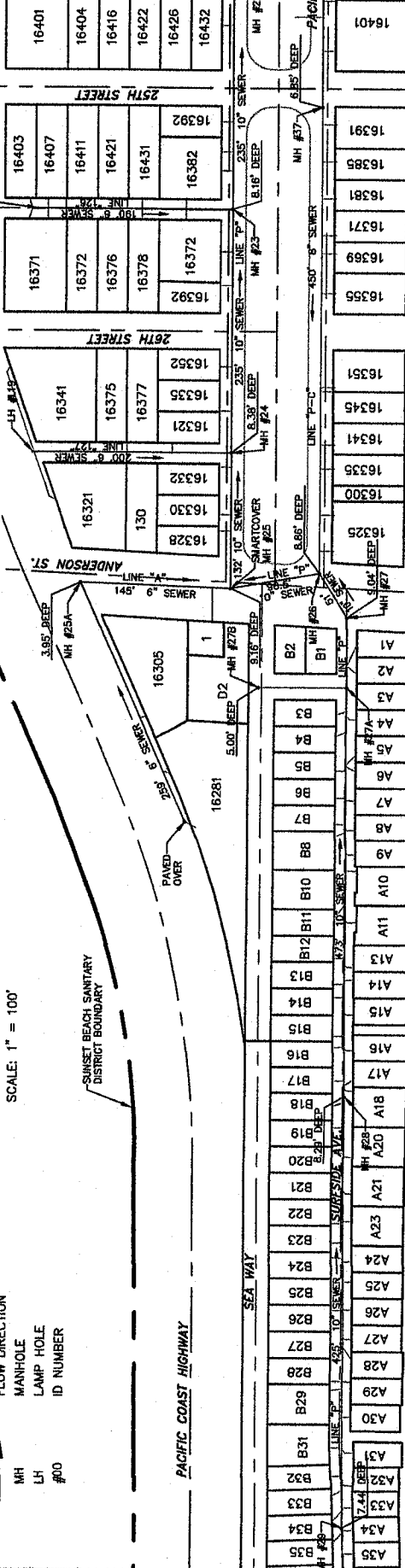

SHEET:

7/9

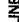

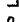
16421	16415	16401
16391	16385	16381
16371	16369	16355
16351	16345	16341
16335	16300	16325
A1	A2	A3
A4	A5	A6
A7	A8	A9
A10	A11	A12
A13	A14	A15
A16	A17	A18
A19	A20	A21
A22	A23	A24
A25	A26	A27
A28	A29	A30
A31	A32	A33
A34	A35	A36
A37	A38	A39
A40	A41	A42
A43	A44	A45
A46	A47	A48
A49	A50	A51
A52	A53	A54
A55	A56	A57
A58	A59	A60
A61	A62	A63
A64	A65	A66
A67	A68	A69
A70	A71	A72
A73	A74	A75
A76	A77	A78
A79	A80	A81
A82	A83	A84
A85	A86	A87
A88	A89	A90
A91	A92	A93
A94	A95	A96
A97	A98	A99
A100		

LEGEND

-  SLIP LINED SEWER LINE
-  SEWER LATERAL
-  PROPERTY LINE
-  BY-PASS PRESSURE LINE
-  STREET CENTERLINE
-  FLOW DIRECTION
-  MANHOLE
-  LAMP HOLE

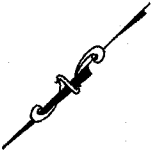

SCALE: 1" = 100'

PACIFIC COAST HIGHWAY
 SUNSET BEACH SANITARY DISTRICT BOUNDARY

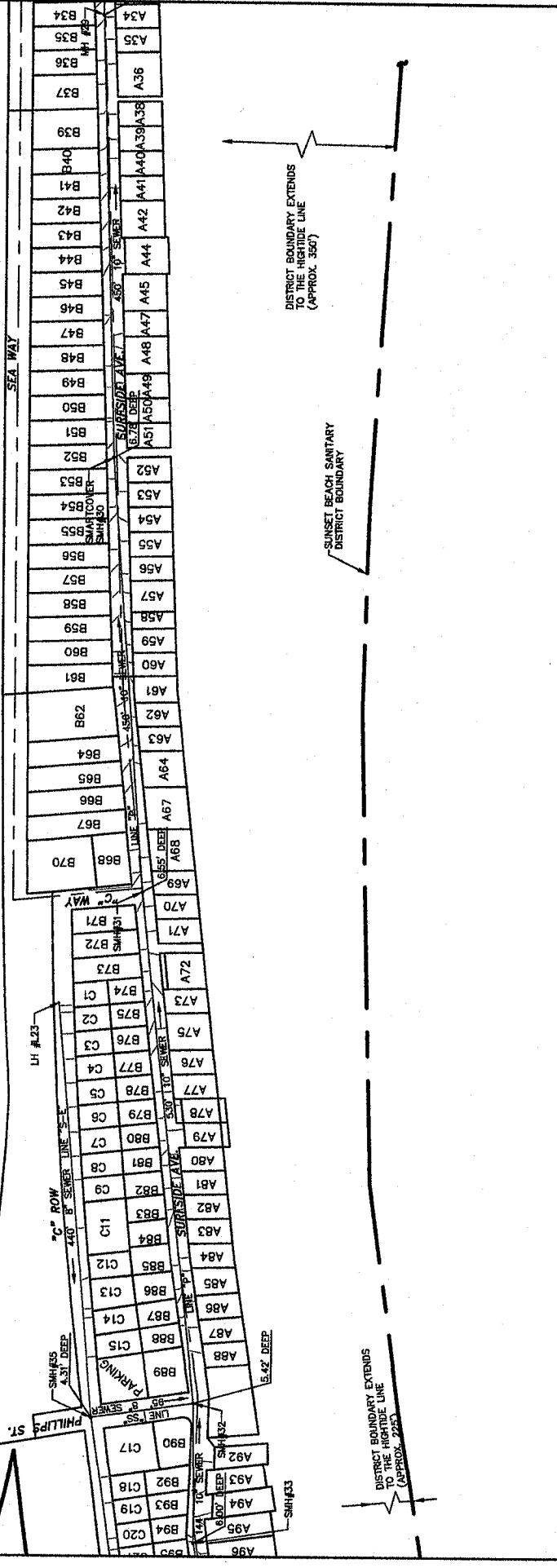

**SUNSET BEACH SANITARY DISTRICT
 SEWER MASTER PLAN
 FACILITIES MAP**

SHEET: 8/9



JONES, CAHILL & ASSOCIATES
 CONSULTING ENGINEERS
 18000 Pacific Coast Highway, Suite 200, Sunset Beach
 California 92688 - (714) 846-0556
 e-mail: jca@jonescahill.com

LEGEND

- SLIP LINED SEWER LINE
- SEWER LATERAL
- PROPERTY LINE
- BY-PASS PRESSURE LINE
- STREET CENTERLINE
- FLOW DIRECTION
- MANHOLE
- LAMP HOLE
- ID NUMBER



SCALE: 1" = 100'

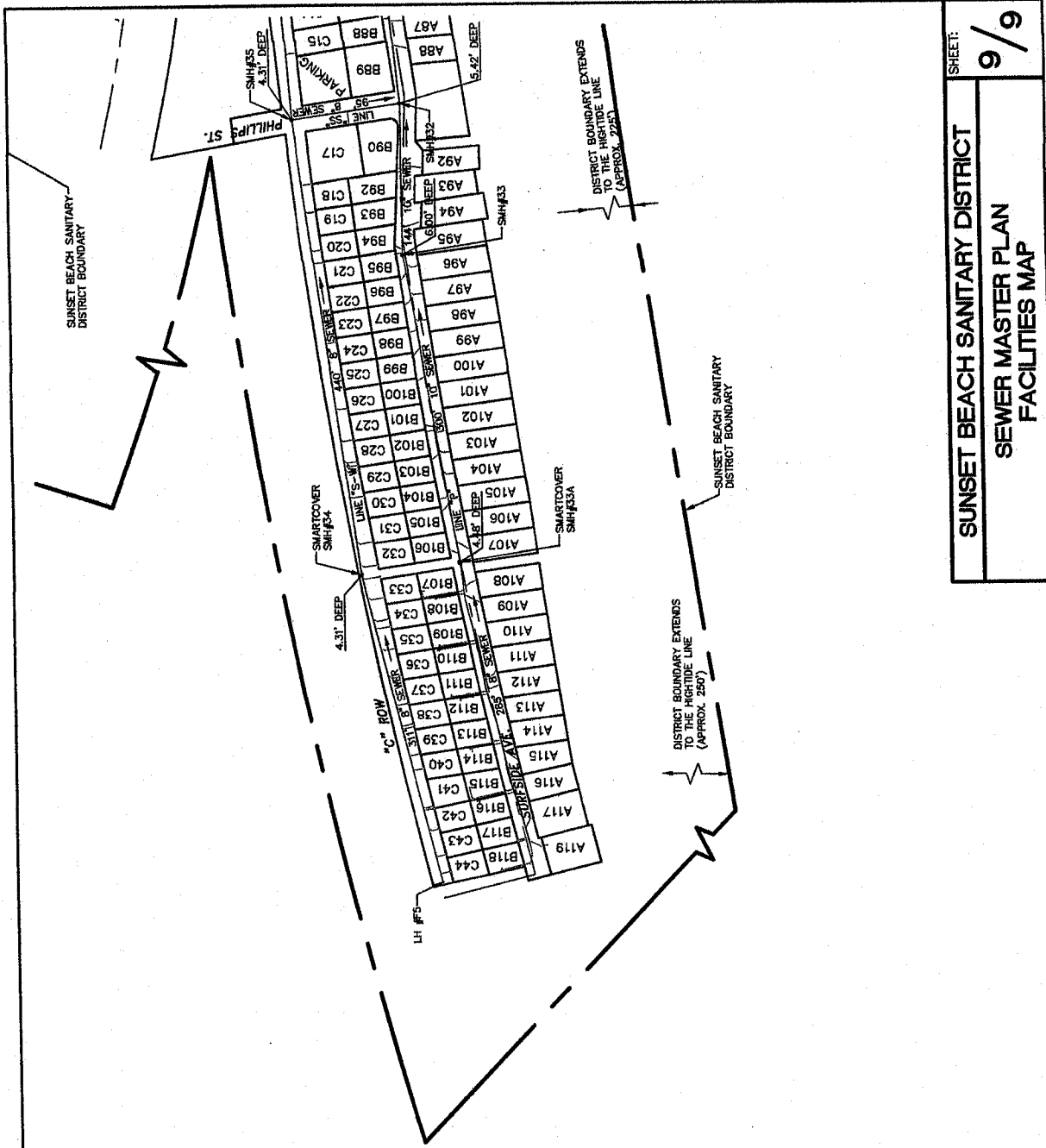

JONES, CAHILL & ASSOCIATES
CONSULTING ENGINEERS
18090 Beach Boulevard - Huntington Beach
California 92648 - (714) 848-0565
e-mail: jca@jonescahill.com

1. PCH at Anderson Street

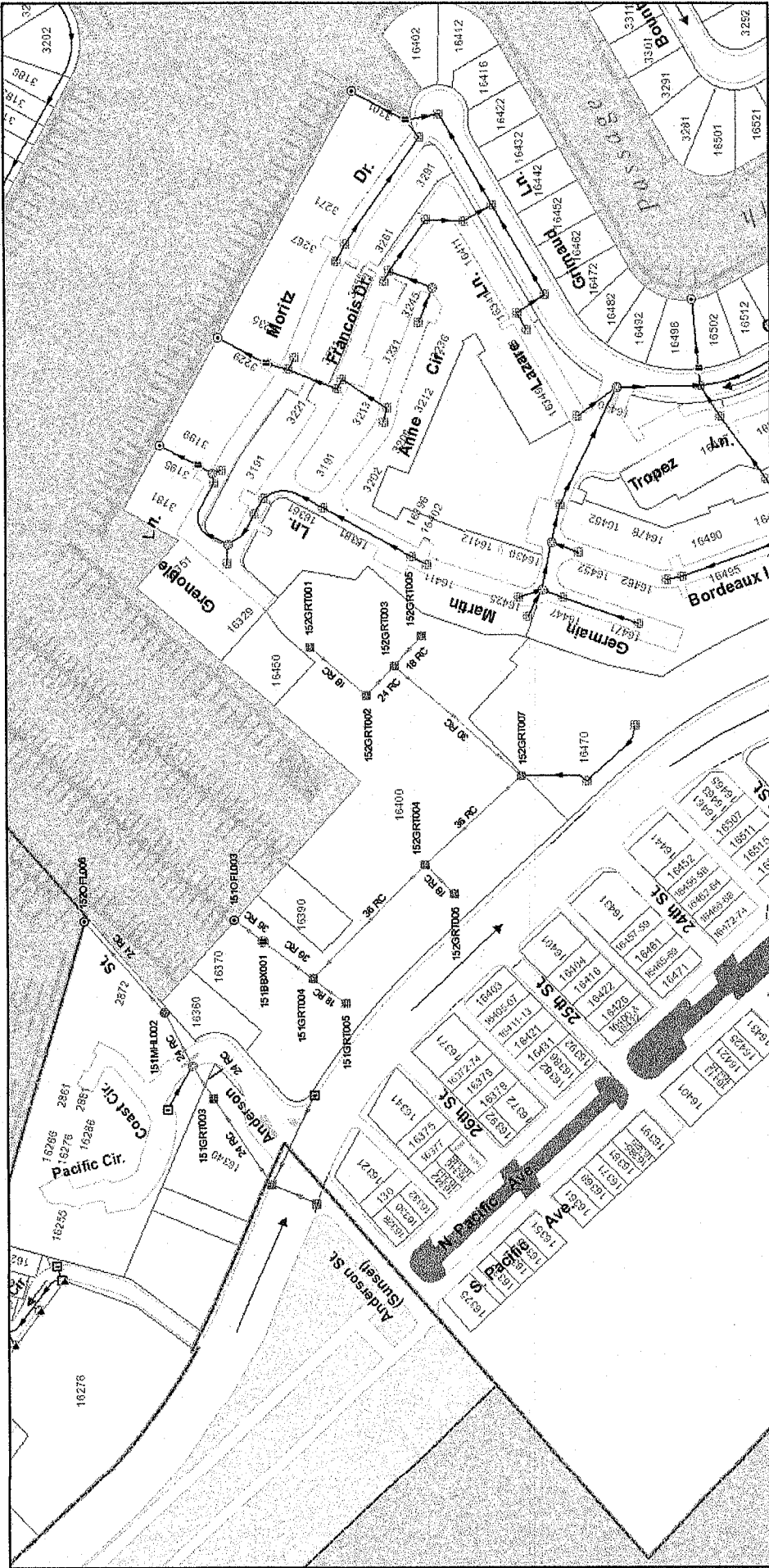

1/31/2023, 6:30:52 AM

- | | | | | |
|---|---|--|---|--|
| <ul style="list-style-type: none"> — Half Round — Box Drain — Half Round — Junction Box — Storm Pipes — City of Huntington Beach — County of Orange — Private | <ul style="list-style-type: none"> — City of Westminster — City of Fountain Valley — State of California — Storm Features — Baffle Box, City of Huntington Beach — Baffle Box, Private — CDS Unit, City of Huntington Beach — CDS Unit, Private | <ul style="list-style-type: none"> □ Catch Basin, City of Fountain Valley □ Catch Basin, City of Huntington Beach □ Catch Basin, City of Westminster □ Catch Basin, County of Orange □ Catch Basin, Private □ Catch Basin, State of California □ Catch Basin, Unknown | <ul style="list-style-type: none"> ⊗ Clarifier, City of Huntington Beach ⊗ Clarifier, Private ⊗ Cleanout, City of Huntington Beach ⊗ Cleanout, City of Westminster ⊗ Cleanout, Private ⊗ Detention Structure, City of Huntington Beach ⊗ Discharge, City of Huntington Beach | <ul style="list-style-type: none"> ■ Discharge, County of Orange ■ Discharge, Private ■ Forebay, City of Huntington Beach ■ Forebay, County of Orange ■ Forebay, Private ■ Grate, City of Huntington Beach ■ Grate, City of Westminster |
|---|---|--|---|--|

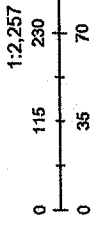

City of Huntington Beach

Huntington Beach Public Works
City of Huntington Beach I

2. PCH at Admiralty Drive

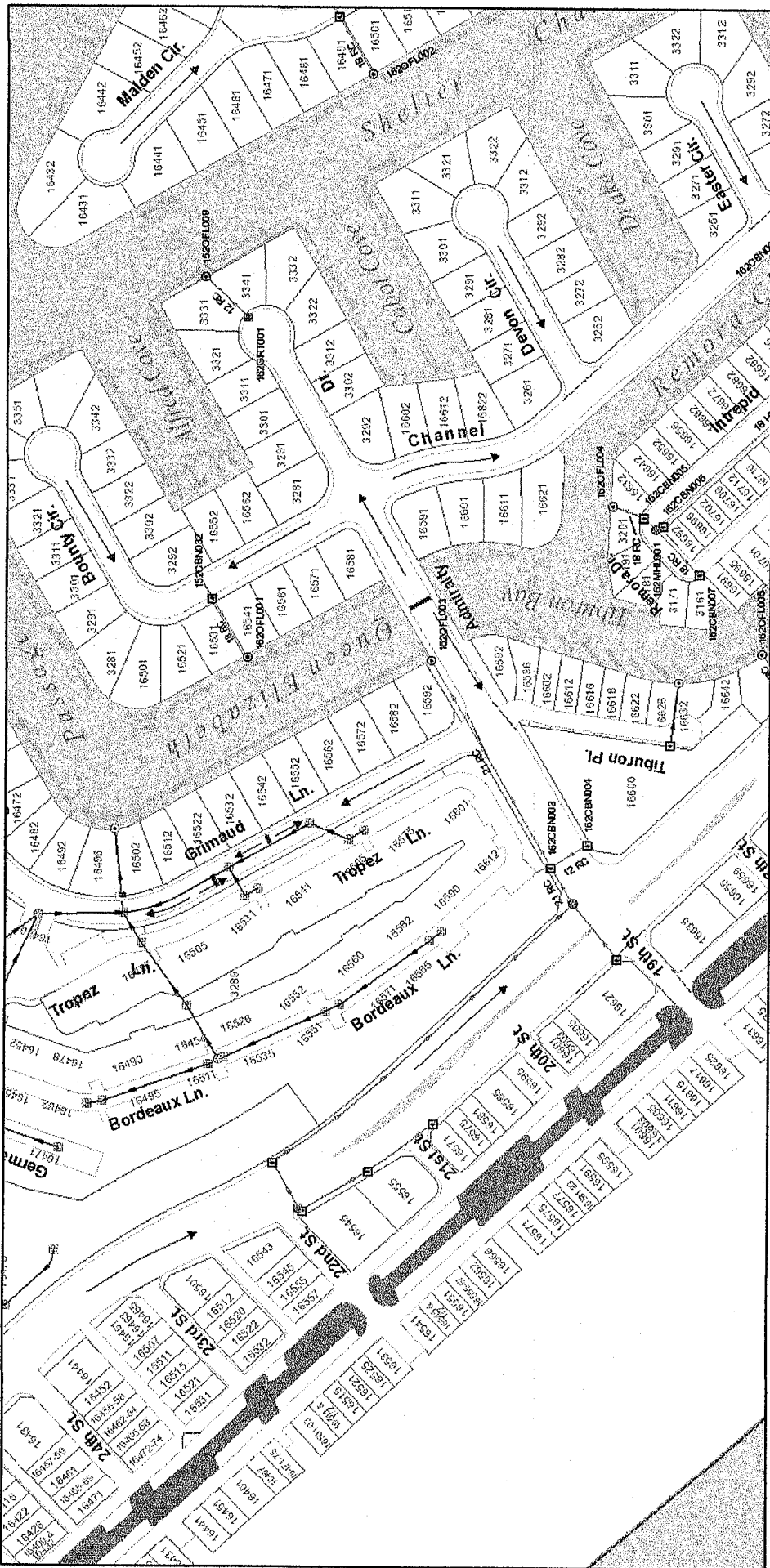

1/31/2023, 6:33:46 AM

- Half Rounds
- City of Westminster
 - City of Fountain Valley
 - State of California
 - Storm Features
 - Baffle Box, City of Huntington Beach
 - Baffle Box, Private
 - CDS Unit, City of Huntington Beach
 - CDS Unit, Private
 - Box Drain
 - Half Round
 - Junction Box
 - Storm Pipes
 - City of Huntington Beach
 - County of Orange
 - Private
 - Catch Basin, City of Fountain Valley
 - Catch Basin, City of Huntington Beach
 - Catch Basin, City of Westminster
 - Catch Basin, County of Orange
 - Catch Basin, Private
 - Catch Basin, State of California
 - Catch Basin, Unknown
 - Clarifier, City of Huntington Beach
 - Clarifier, Private
 - Cleanout, City of Huntington Beach
 - Cleanout, City of Westminster
 - Cleanout, Private
 - Detention Structure, City of Huntington Beach
 - Discharge, City of Huntington Beach
 - Discharge, County of Orange
 - Discharge, Private
 - Forebay, City of Huntington Beach
 - Forebay, County of Orange
 - Forebay, Private
 - Grate, City of Huntington Beach
 - Grate, City of Westminster

1:2,257

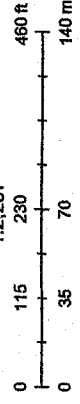

City of Huntington Beach

Huntington Beach Public Works
City of Huntington Beach |

3. PCH at Broadway

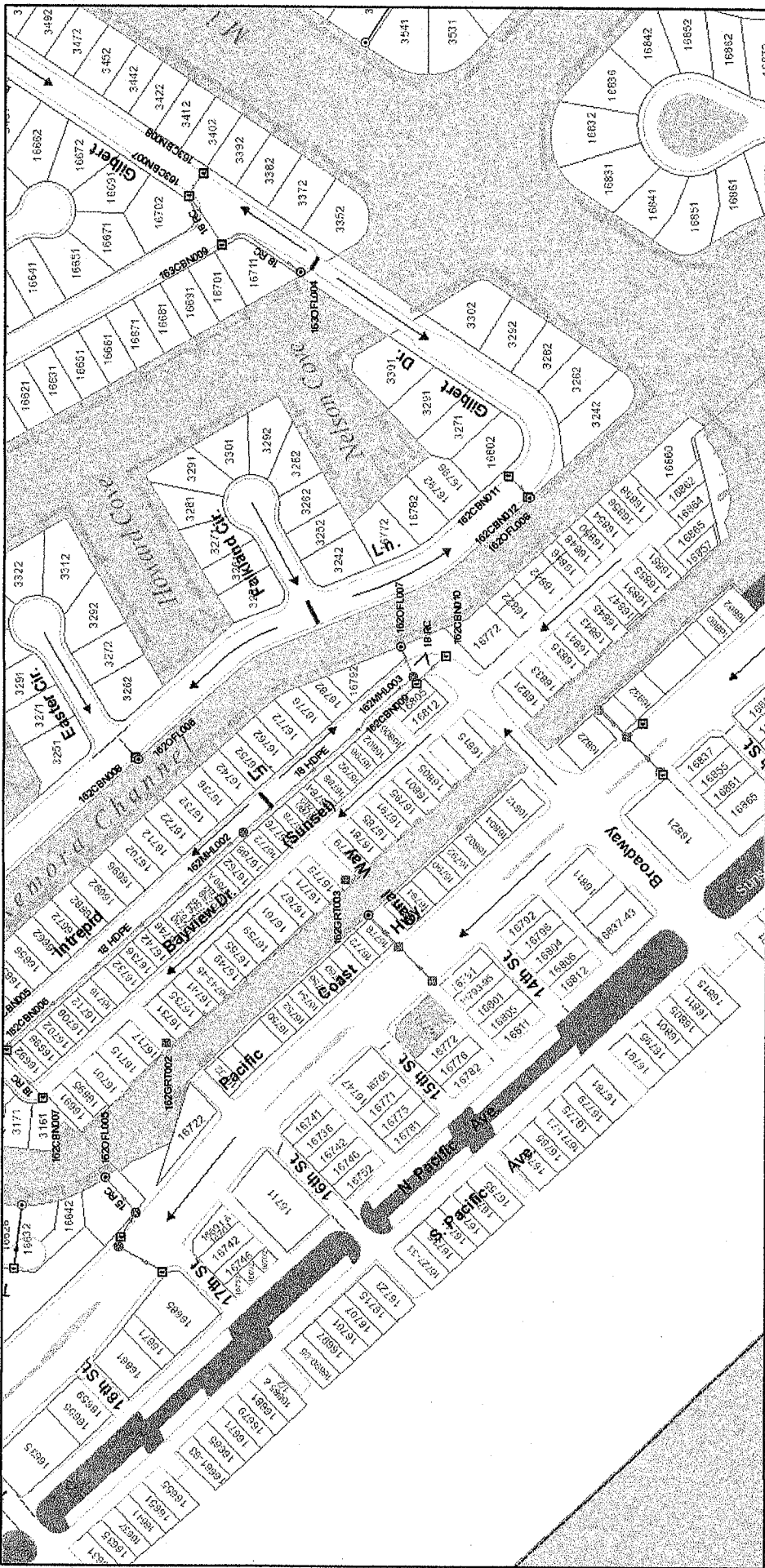

1/31/2023, 6:36:41 AM

1:2,257

0 115 230 460 ft

0 35 70 140 m

City of Huntington Beach

■ Discharge, County of Orange
 ■ Discharge, Private
 ■ Forebay, City of Huntington Beach
 ■ Forebay, County of Orange
 ■ Forebay, Private
 ■ Grate, City of Huntington Beach
 ■ Grate, City of Westminster

□ Catch Basin, City of Fountain Valley
 □ Catch Basin, City of Huntington Beach
 □ Catch Basin, City of Westminster
 □ Catch Basin, County of Orange
 □ Catch Basin, Private
 □ Catch Basin, State of California
 □ Catch Basin, Unknown

□ Clarifier, City of Huntington Beach
 □ Clarifier, Private
 □ Cleanout, City of Huntington Beach
 □ Cleanout, City of Westminster
 □ Cleanout, Private
 □ Detention Structure, City of Huntington Beach
 □ Discharge, City of Huntington Beach

□ City of Westminster
 □ City of Fountain Valley
 □ State of California
 Storm Features
 * Baffle Box, City of Huntington Beach
 * Baffle Box, Private
 * CDS Unit, City of Huntington Beach
 * CDS Unit, Private

□ City of Westminster
 □ City of Fountain Valley
 □ State of California
 Storm Features
 * Baffle Box, City of Huntington Beach
 * Baffle Box, Private
 * CDS Unit, City of Huntington Beach
 * CDS Unit, Private

Huntington Beach Public Works
City of Huntington Beach |

4. PCH south of Broadway

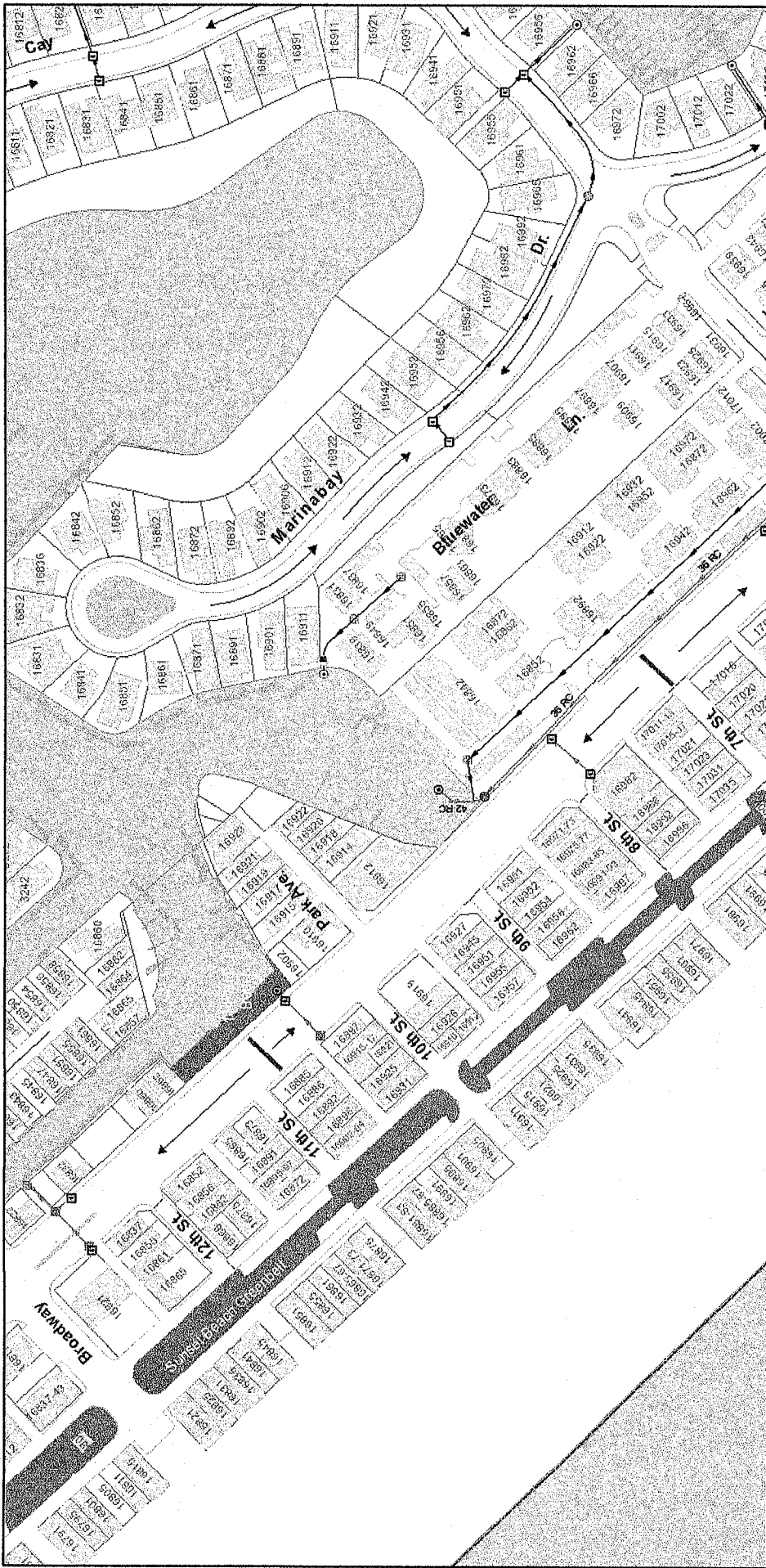

4/4/2022, 7:23:13 PM

- Half Rounds
- Box Drain
- Half Round
- Junction Box
- Storm Pipes
- City of Westminster
- City of Fountain Valley
- State of California
- Storm Features
- Baffle Box, City of Huntington Beach
- Baffle Box, Private
- CDS Unit, City of Huntington Beach
- Private
- City of Westminster
- City of Fountain Valley
- State of California
- Storm Features
- Baffle Box, City of Huntington Beach
- Baffle Box, Private
- CDS Unit, City of Huntington Beach
- Private
- Catch Basin, City of Westminster
- Catch Basin, City of Huntington Beach
- Catch Basin, City of Westminster
- Catch Basin, County of Orange
- Catch Basin, Private
- Catch Basin, State of California
- Catch Basin, Unknown
- Clarifier, City of Huntington Beach
- Clarifier, Private
- Cleanout, City of Huntington Beach
- Cleanout, City of Westminster
- Cleanout, Private
- Detention Structure, City of Huntington Beach
- Discharge, City of Huntington Beach
- Discharge, County of Orange
- Discharge, Private
- Forebay, City of Huntington Beach
- Forebay, County of Orange
- Forebay, Private
- Grate, City of Huntington Beach
- Grate, City of Westminster

1:2,257

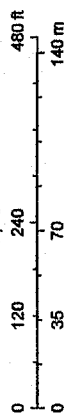

Huntington Beach Public Works

5. PCH north of Warner

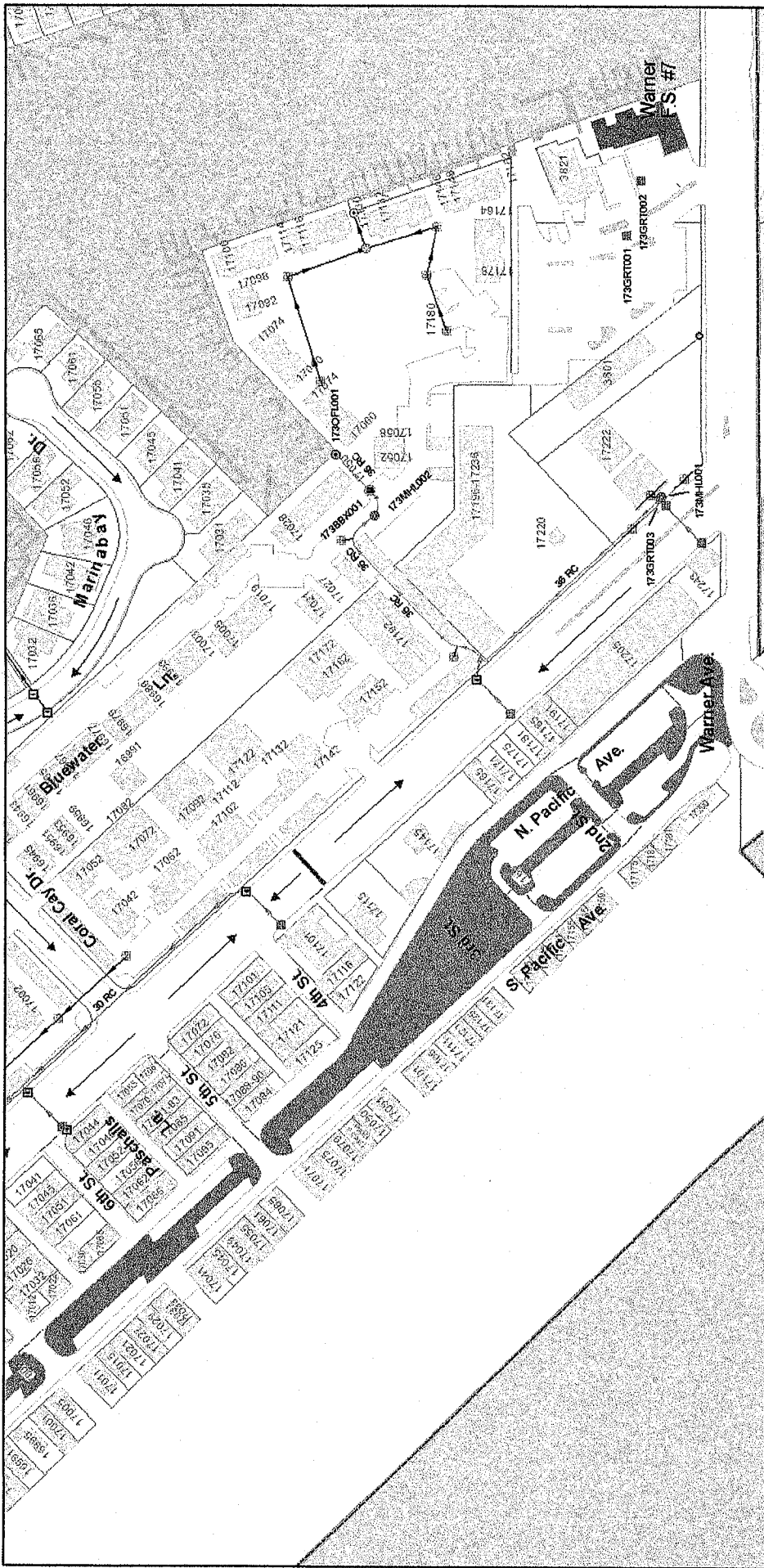

4/14/2022, 7:21:28 PM

- | | | | |
|--|--|---|--|
| <ul style="list-style-type: none"> — Half Rounds — City of Westminster — City of Fountain Valley — State of California Storm Features — Storm Pipes — City of Huntington Beach — County of Orange — Private | <ul style="list-style-type: none"> □ Catch Basin, City of Fountain Valley □ Catch Basin, City of Huntington Beach □ Catch Basin, City of Westminster □ Catch Basin, County of Orange □ Catch Basin, Private □ Catch Basin, State of California □ Catch Basin, Unknown | <ul style="list-style-type: none"> ⊗ Clarifier, City of Huntington Beach ⊗ Clarifier, Private ⊗ Cleanout, City of Huntington Beach ⊗ Cleanout, City of Westminster ⊗ Cleanout, Private ⊗ Detention Structure, City of Huntington Beach ⊗ Discharge, City of Huntington Beach | <ul style="list-style-type: none"> ■ Discharge, County of Orange ⊗ Discharge, Private ⊗ Forebay, City of Huntington Beach ⊗ Forebay, County of Orange ⊗ Forebay, Private ⊗ Grate, City of Huntington Beach ⊗ Grate, City of Westminster |
|--|--|---|--|

